

SECTION A-A

PANEL CUT-OUT

$\phi 1.281 [32.54]$

1.125 [28.58]

0.1875 [4.76]
Max Terminal Lug
Thickness

$\phi 1.650 [41.91]$

1.750 [44.45]

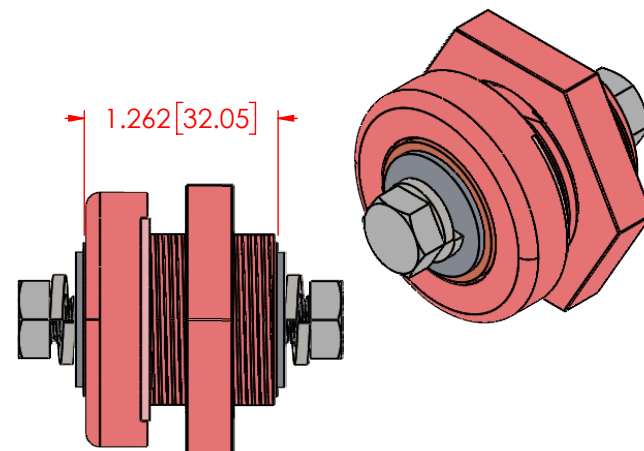

REVISIONS

REV.	DESCRIPTION	DATE	APPROVED
A	80 IN./LBS. [9.0Nm] was 120 IN./LBS. [13.56Nm]	9/16/2024	RAS
B	Added "Bulk Packed" Note	9/19/2024	RAS

BULK PACKED SEPERATELY

ITEM NO.	PART NUMBER	DESCRIPTION	QTY.
1	3960-005	Norseal Red Silicone Gasket	1

ITEM NO.	PART NUMBER	DESCRIPTION	QTY.
2	3730-016	5/16"-24 18-8 Stainless Steel Bolt .625" Long	2
3	3638-002	M8 18-8 Stainless Steel Lock Washer	2
4	3645-000	5/16" 18-8 Stainless Steel Flat Washer	2
5	3648-010	1/2" Copper Contact Washer	2
6	362N0N02	Nylon Power Bushing Housing (Red)	1
7	359N0N02	Glass Filled Nylon Locking Nut (Red)	1
8	3865-002	5/16"-24 Threaded Copper Core	1
9	3962-000	SBR Rubber Grommet	1

CABLE TEMP RATING : 60c 90c 105c 125c
CURRENT RATING @ 12vdc : 275A 380A 440A 490A
TEMPORARY MAX @ 12vdc : 305A 415A 475A 535A

MAXIMUM VOLTAGE : 48 VDC

MATERIAL PART NO: 7111210502
MATERIAL: GLASS FILLED NYLON
VENDOR PART NO: HYLON N2015 NAT

MAX 5/16" FASTENER TORQUE: 144 IN./LBS. [16.27 Nm]
MAX NYLON NUT TORQUE: 80 IN./LBS. [9.0 Nm]

Assembly Weight : 0.24 Lbs. [108.8g]

Assembly Color : Red

ALL DIMENSIONS GIVEN AS : INCH [METRIC]
TOLERANCES UNLESS OTHERWISE SPECIFIED :
MOLDED PRODUCTS : $\pm .030"$ / $\pm 0.8\text{mm}$
HARDWARE PRODUCTS : $\pm .010"$ / $\pm 0.25\text{mm}$

PRINTED COPIES ARE NOT CONTROLLED

PROPRIETARY AND CONFIDENTIAL

THE INFORMATION CONTAINED IN THIS
DRAWING IS THE SOLE PROPERTY OF
VTE INCORPORATED. ANY REPRODUCTION
IN PART OR AS A WHOLE WITHOUT THE WRITTEN
PERMISSION OF VTE INCORPORATED PROHIBITED.



VTE INCORPORATED

5437 Robinson Road, P.O. Box 790
Pellston, Michigan 49769 USA
Telephone : 1-800-527-9256, 231-539-8000
Fax : 231-539-0914, EFax : 231-344-5914

REV **B**
SIZE **A**

NAME	DATE
DRAWN BY: RAS	3-22-23
CHECKED BY: PJK	3-22-23
DO NOT SCALE DRAWING	

TITLE:
5/16" Waterproof Power Bushing with .625" Long Bolts

DWG. NO.

ICB316N02